



elam[®]

BUILDING THE FUTURE

HARERA REGISTRATION NO. 125 DATED 12.12.2025



NOT JUST LIVING,
A STATEMENT OF
WHO YOU ARE.

Shah Rukh Khan

An icon of global stature proudly representing the vision, the project gains a voice as enduring as its architecture. This is where world-class design meets legendary presence, creating an address that embodies success, ambition and legacy in every detail.

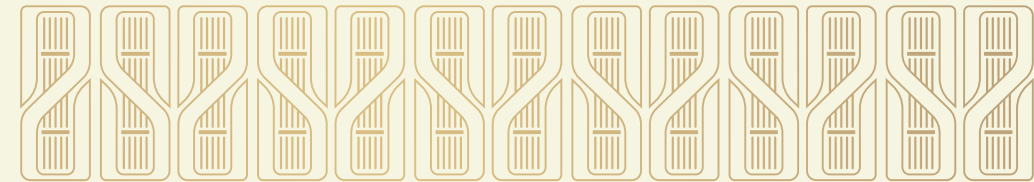



TWO RESPECTED NAMES.
ONE PROMISE,
BUILT ON TRUST.

**ELAN GROUP ONBOARDS
TATA PROJECTS**

FOR THE
CONSTRUCTION OF
ELAN
THE STATEMENT

THE WAY WE BUILD

Elan has never merely built spaces. We sculpt experiences, each more breathtaking than the last. And our latest masterpiece isn't just grander, it's a new paradigm of opulence, innovation and exclusivity.

It is a vision brought to life.





ONE STATEMENT HAS
THE POWER TO CHANGE LIFE
AS YOU KNOW IT

Imagine a shimmering golden-glass silhouette rising against the Gurugram skyline. We've made it real with our newest launch. And we call it 'The Statement'. Set in the prime location of Sector 49, this ultra-luxury landmark is wrapped in an iconic full-glass facade that reflects the sky and sunlight with equal grace. But this isn't just about elegance. Ease is equally a priority.

The Statement offers unmatched connectivity.

NH-8, SPR, Golf Course Extension Road and the Delhi-Mumbai Expressway; all lie just a heartbeat away, making every journey as effortless as it should be.

A ONCE-IN-A-GENERATION RESIDENCE

Crafted with World-Class Architecture and an
Ecosystem of Exceptional Living.





HOMES THAT ECHO THROUGH TIME

Elan The Statement is envisioned for generations to come. Defined by thoughtful planning, low-density living and execution-led thinking, it offers a home designed to remain relevant well beyond the present. Every detail is considered to create residences that stand the test of time, quietly and purposefully.



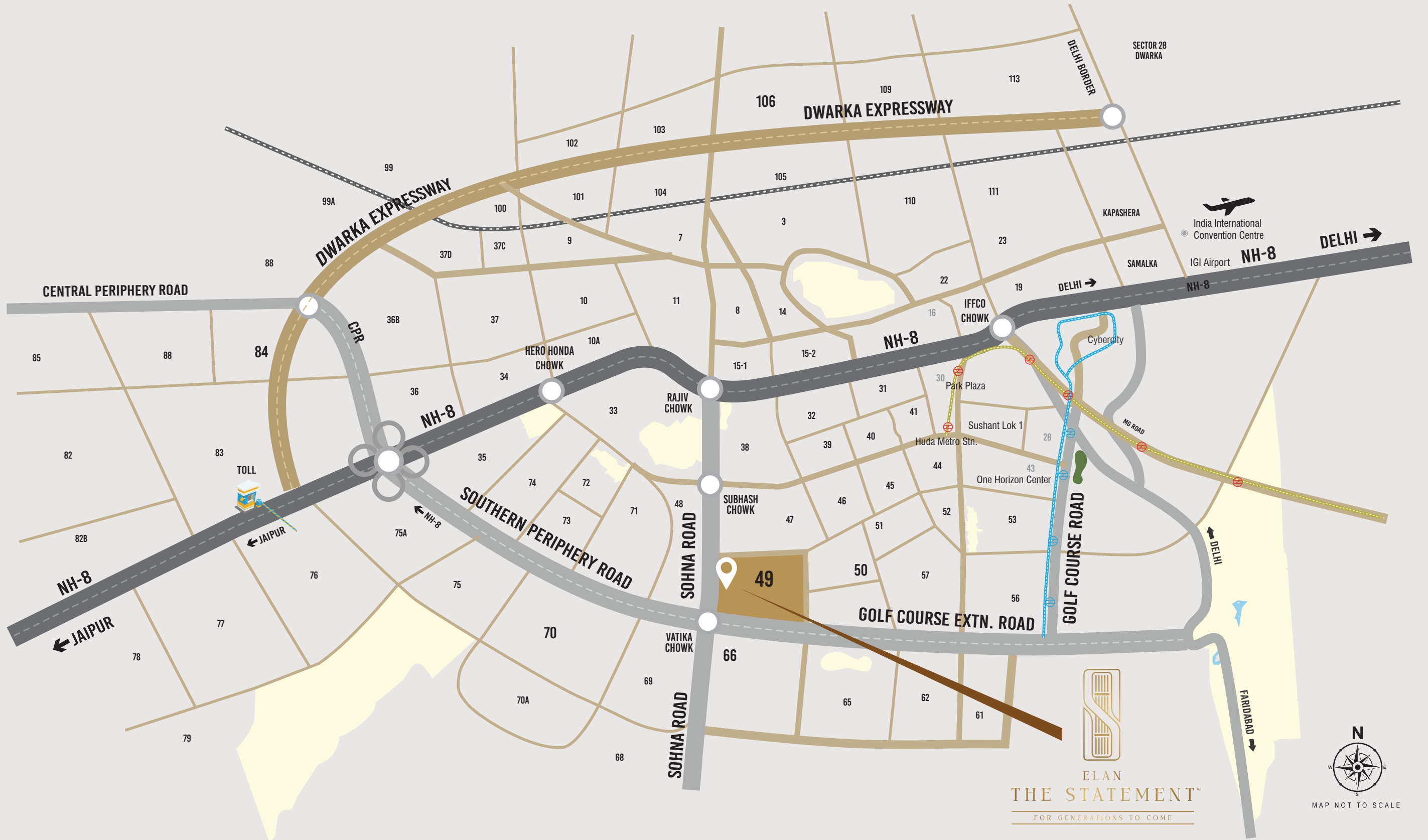

ELAN
THE STATEMENT™
 FOR GENERATIONS TO COME



MAP NOT TO SCALE

THE NEW WAY OF LIVING HAS A NEW ADDRESS SECTOR 49, GURUGRAM

Located in Sector 49, the thriving heart of Gurugram's most dynamic corridor; The Statement is positioned for unmatched convenience . Strategically connected via NH-8, SPR, Golf Course Extension Road and the Dwarka Expressway, it stands in one of Gurugram's most future-forward neighbourhoods. Here, every route brings comfort and every path promises elevated living.





RESIDENTIAL DEVELOPMENT SECTOR 49, SOHNA ROAD

DISCLAIMER: Nothing contained herein intends to constitute a legal offering or a legal binding. This Master Plan is tentative, not final and subject to change. The planning and development will be approved in due course of time after following due process of law. This plan does not replicate the exact development proposed and should not be relied on as a definitive reference. No representations are made regarding existence/continuity of existence of any landmarks /locations shown. The landmarks/locations may be subject to change from time to time. No representation or warranty is made or intended as to the accuracy or completeness of information on this Plan. Before making any decision based on this plan, you are requested to independently, either directly or through your legal/financial consultants, thoroughly verify all details/documents and satisfy yourself. *T&C apply.

ELAN THE STATEMENT™

FOR GENERATIONS TO COME



ELAN
THE STATEMENT

FOR GENERATIONS TO COME

LUXURY THAT'S HARD
TO FIND AND IMPOSSIBLE
TO IGNORE

The Statement is meant for the few who don't just succeed but redefine success. It offers them a home that's crafted to mirror their journey, their stature and the heritage they build. Within these walls, you'll find more than shelter. You'll discover a promise woven into time. A home where every brick holds your today, every corridor whispers your stories and each room waits to carry your legacy forward; for generations to come.

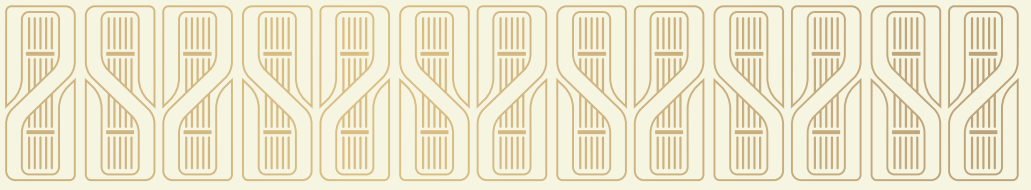

AT THE CENTRE OF EVERYTHING

Situated in a prime, high-growth neighbourhood, The Statement enjoys direct connectivity to NH-8, Dwarka Expressway, SPR and Golf Course Extension Road. The city's finest schools, hospitals, offices and lifestyle destinations surround the development, creating a world of ease and access. It's safe to say that everything you need rests exactly where it should be; reassuringly close.



A COMMUNITY OF DISTINCTION

In the company of Gurugram's most distinguished residential enclaves, The Statement stands amid neighbourhoods that reflect its own elegance and exclusivity. Together, they form a community where luxury is the natural expectation, a way of life woven into every detail.





BENOY

BACKED
BRILLIANCE

In collaboration with Benoy, one of the world's most admired architectural powerhouses, The Statement emerges as a true example of international design. Here, wellness-centric planning flows effortlessly into future-ready thinking, shaping spaces that breathe clarity, balance and enduring sophistication. It is luxury imagined for a new era, crafted to feel both meaningful and modern.





ARCHITECTURE IN PERFECT ALIGNMENT

Spread across a six-acre luxury enclave, The Statement is masterfully envisioned through five ultra-premium high-rise towers. Each tower is placed with intention, ensuring optimal privacy, abundant light and expansive views. Low-density planning defines the development, with only two residences per floor and a private lift lobby reserved solely for your home. The floor layouts are crafted with care, allowing space, openness and premium view corridors to unfold with natural ease. Every element works together in quiet harmony, creating a living experience shaped by balance, refinement and a heightened sense of architectural elegance.





DESIGNED TO STAND APART

Rising on an iconic frontage with a thoughtfully elevated plinth, The Statement is crafted for visibility, privacy and distinction. Its premium orientation invites abundant light, expansive views and a sense of natural comfort. Every element enhances the luxury of everyday living, making presence itself a privilege.



A SILHOUETTE THAT COMMANDS THE SKYLINE

The Statement rises in a sleek cascade of glass, expressing modern sophistication in its purest form. Its vertical presence cuts a bold figure against the horizon. And when the sun sets, its luminous identity transforms the tower into a radiant landmark; distinctive, memorable and impossible to overlook.





SPACE, PRIVACY AND EXCLUSIVITY

Designed for elevated living, The Statement offers expansive 4 BHK residences defined by generous layouts, suite-style bedrooms and gourmet kitchens; all brought together with thoughtful, intuitive planning. With only two residences on each floor and a private lift lobby dedicated to your home, every detail enhances a life of rare privacy, openness and effortless comfort.

GOLDEN
GLASS
FACADE

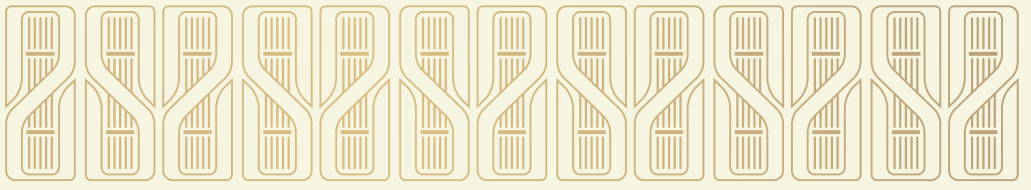

TWO UNITS
PER FLOOR

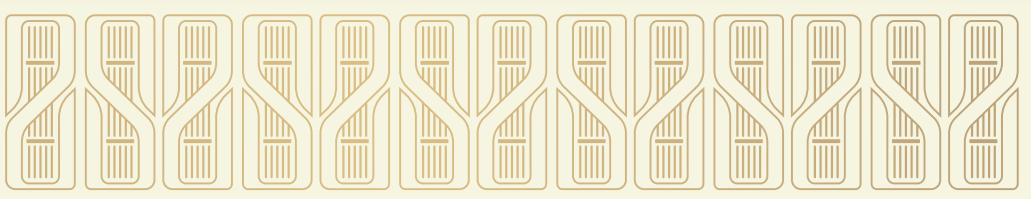

PRIVATE
ELEVATOR

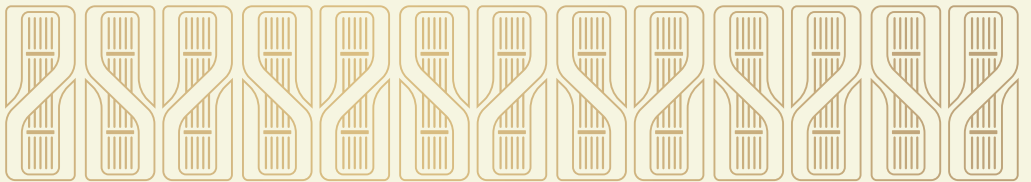

OR SECT 49,
OR SECT 49,
OR SECT 49,
OR SECT 49,
OR SECT 49,
OR SECT 49,
OR SECT 49,
OR SECT 49,
OR SECT 49,
OR SECT 49,

TRIPLE HEIGHT LOBBY

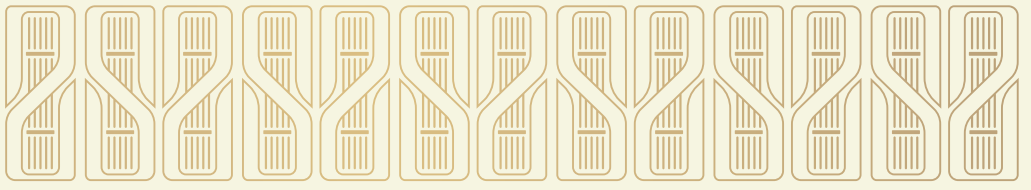



EVERY DETAIL CRAFTED
FOR AN EXTRAORDINARY LIFESTYLE

50+ AMENITIES





A WORLD OF CURATED LUXURY

The Statement's clubhouse brings wellness, recreation and fine living together with an effortless sense of ease. This feeling extends into the homes, where only two apartments per floor and a private lift lobby create rare privacy. The spacious 4 BHK layouts are planned with clarity, balancing comfort with intelligent, intuitive design.

The development is engineered for Zone-5 structural safety standards, surpassing the region's Zone-4 requirement.

High-performance glazing ensures deep noise insulation, while full home automation offers seamless control over lighting, climate and smart features. Residents enjoy 24×7 hot and cold water and breathe cleaner air through a centralised purification system in every tower. Thoughtful conveniences continue with fully loaded modular kitchens and a garbage chute on each floor. Even the outdoors are crafted with care, with mosquito-free landscaped areas completing a living experience shaped by comfort and modern luxury.



AMENITIES CRAFTED AROUND YOU

The clubhouse is shaped as a haven of balance and pleasure, offering the quiet promise that something special awaits at every turn. Residents can unwind in the indoor heated pool or step into the outdoor Olympic-sized heated pool for a more expansive escape. The spa deepens the experience with onsen, snow and hot baths, along with private wellness suites and an oxygen room. A fully equipped gym, yoga studio and Pilates studio complete the holistic wellness circuit. Entertainment unfolds across a 60-seater gold-class auditorium, a shooting range and a digital gaming arena. Sporting options extend further with courts for squash, badminton, tennis and pickleball, along with a half basketball court for casual play. Social spaces introduce warmth and sophistication through a cigar lounge and a bar lounge. Concierge and valet services add ease to everyday life, with a departmental store bringing the amenities to a thoughtful and well-rounded close.



INDULGE IN TIMELESS
LUXURY, PERFECTED IN
EVERY DETAIL

01

- Spalon by Levo Aesthetics for holistic self-care
- Outdoor heated swimming pool
- Indoor swimming pool with jacuzzi
- Snow bath
- Hot bath
- Wine testing area
- Pet wellness club
- Spa

levo
AESTHETICS

FOR SENIORS

02

- Everyday Wellness by Fortis Memorial Research Institute
- Amenities for the elderly
- Meditation Room
- Wellness oriented space



Artistic illustration

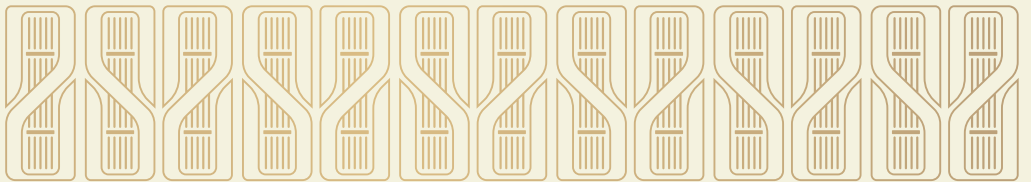

FOR KIDS

03

- Skating rink
- Trampoline and crèche
- Climbing wall
- Kids' play area
- Digital and virtual gaming zone



Artistic illustration



SPORTS
AND WELLNESS

04

- Shooting Range
- Pilates room
- Yoga Room
- Gym
- Badminton court
- Squash court
- Pickleball court
- Half basketball court
- Lawn tennis court



Artistic illustration



LANDSCAPE
AND OUTDOOR

05

- Gardens
 - Reflexology Park
 - Zen Garden
 - Vertical Hanging Garden
- Pet Zone Outside
- Jogging Track
- Mosquito free area in landscape

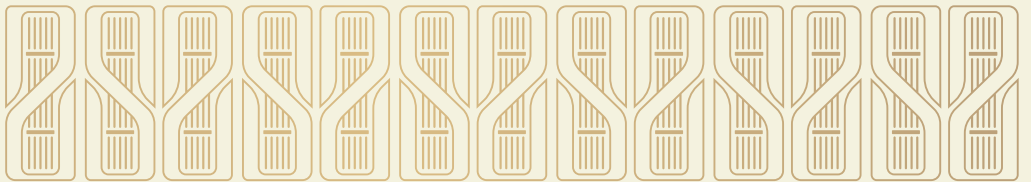

LUXURY AND
DINING SPACES

06

- Restaurant
- Card room
- Bar lounge
- Sports Bar (Pool Table, TT Table & Foosball Table)
- Party lounge/ banquet
- Cigar Lounge
- Health Café/Detox Juice Bar
- Café



Artistic illustration



UNIQUE
HIGHLIGHTS

07

- Auditorium
- Library
- Business centre
- Car wash area in basement
- Music and sound jamming room
- Karaoke room



Artistic illustration

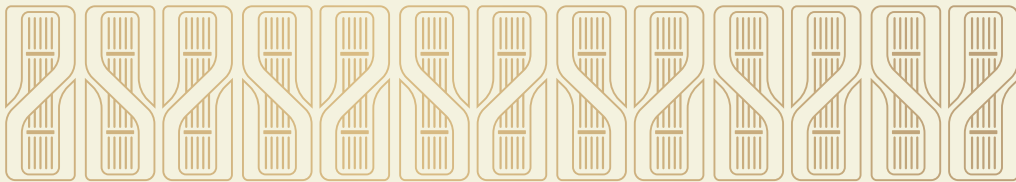

CONCIERGE
CONVENIENCE

08

- Concierge desk
- Valet Parking

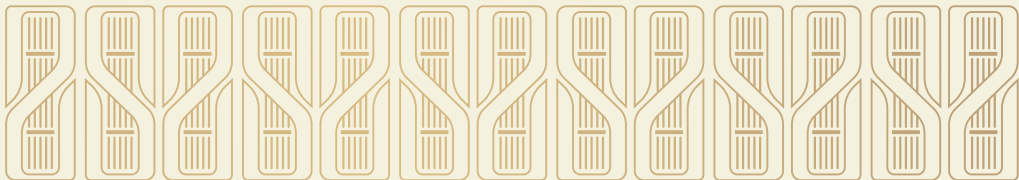

Artistic illustration

PREMIUM
RESIDENTIAL
FEATURES

09

- 24x7 hot water supply
- Departmental Store
- Dedicated Garbage Chute
- Commercial Space



Artistic illustration



SUSTAINABLE
AND SMART LIVING

10

- DGU-External glazing
- Electric Charging point in Landscape



Artistic illustration

PROJECT SPECIFICATIONS





ELAN
THE STATEMENT
FOR GENERATIONS TO COME

SPECIFICATIONS

LIVING/DINING/ FOYER/ LOUNGE/PASSAGE

Floor	Imported Marble / Engineered Stone or Equivalent
Wall	Premium Grade Acrylic Emulsion Paint Finish with Gypsum Plaster
Ceiling	Premium Grade Acrylic Emulsion Paint Finish with Gypsum Plaster

MASTER SUITE

Floor	Imported Marble / Engineered Stone or Equivalent
Wall	Premium Grade Acrylic Emulsion Paint Finish with Gypsum Plaster
Ceiling	Premium Grade Acrylic Emulsion Paint Finish with Gypsum Plaster

MASTER BEDROOM, JUNIOR MASTER BEDROOM & OTHER BEDROOM

Floor	Engineered Wooden Flooring or Equivalent
Wall	Premium Grade Acrylic Emulsion Paint Finish with Gypsum Plaster
Ceiling	Premium Grade Acrylic Emulsion Paint Finish with Gypsum Plaster

AUTOMATION

Master Suite, Living - Dining Area	Automation for LIGHTING, Air Conditioning & CURTAINS
Other Bedrooms	Provision for automation for LIGHTING, Air Conditioning & CURTAINS



Artistic illustration

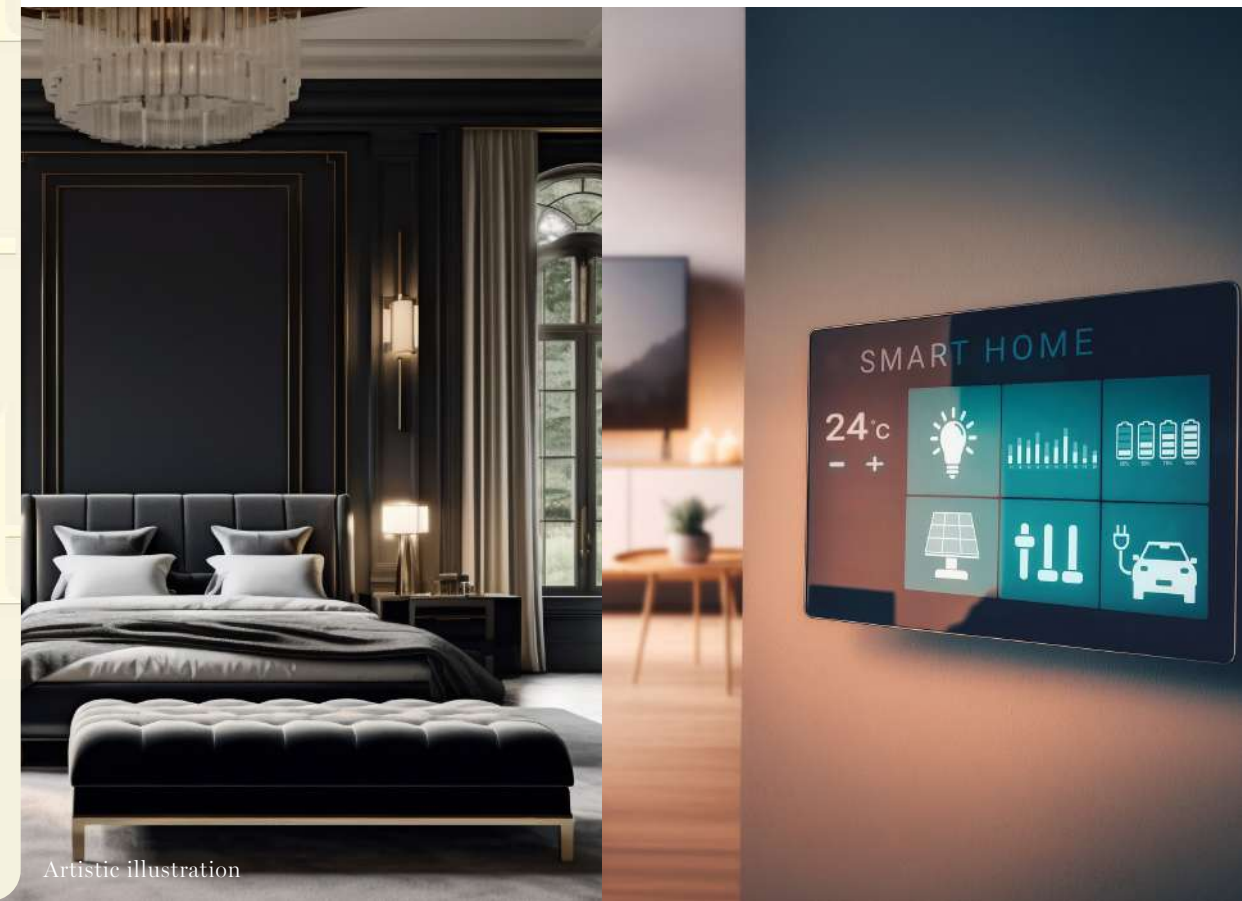

Artistic illustration





ELAN
THE STATEMENT
FOR GENERATIONS TO COME

SPECIFICATIONS

MASTER SUITE TOILET

Floor	Imported Marble / Engineered Stone or Equivalent
Wall	Combination of Stone with Gypsum Plaster & Acrylic Emulsion Paint
Ceiling	Moisture Resistant False Ceiling with Acrylic Emulsion Paint
Fixtures/Fittings	Shower Glass Partition
	Vanity with Marble / Granite countertop or Equivalent and Mirror
	Geysers (Centralized / Individual of A.O. Smith / Venus / Racold or Equivalent Make)
	Rain Shower in MASTER SUITE TOILET
Sanitary ware	TOTO / Duravit or Equivalent Make (Automatic WC in Master Suite Toilet)
CP Fittings	TOTO / Hansgrohe or Equivalent Make
Toilet Accessories	TOTO / Hansgrohe or Equivalent Make

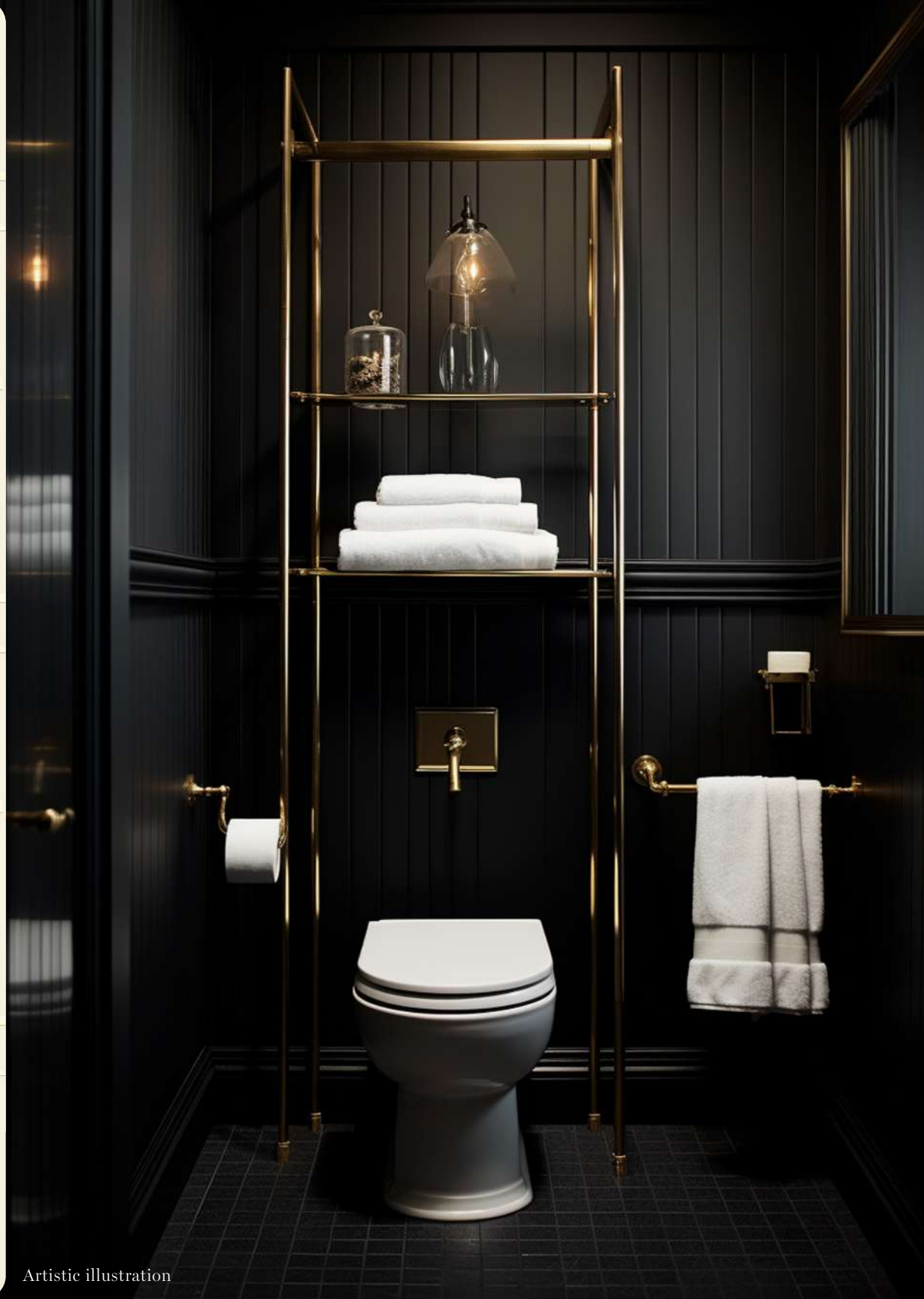

Artistic illustration

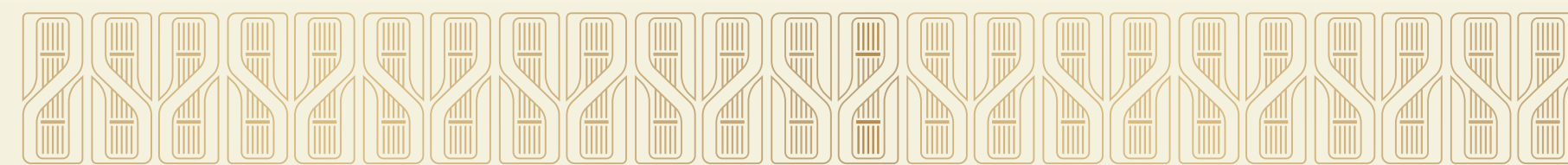



ELAN
THE STATEMENT
FOR GENERATIONS TO COME

SPECIFICATIONS

MASTER BEDROOM TOILET, JUNIOR MASTER BEDROOM TOILET & OTHER TOILET

Floor	Premium Quality Vitrified / Anti-Skid Tiles or Equivalent
Wall	Combination of Premium Vitrified Tiles with Gypsum Plaster & Acrylic Emulsion Paint
Ceiling	Moisture Resistant False Ceiling with Acrylic Emulsion Paint
Fixtures/Fittings	Shower Partition
	Vanity with Marble / Granite countertop or Equivalent and Mirror
	Geyser (Centralized / Individual of A.O. Smith / Venus / Racold or Equivalent Make)
	Rain Shower in Master Bedroom
Sanitary ware	TOTO / Duravit or Equivalent Make
CP Fittings	TOTO / Hansgrohe or Equivalent Make
Toilet Accessories	TOTO / Hansgrohe or Equivalent Make



Artistic illustration





ELAN
THE STATEMENT
FOR GENERATIONS TO COME

SPECIFICATIONS

KITCHEN

Floor	Premium Quality Vitrified / Anti-Skid Tiles or Equivalent
Wall	Combination of Premium Vitrified Tiles / Lacquered Glass Backsplash / Granite & Acrylic Emulsion Paint
Ceiling	Premium Grade Acrylic Emulsion paint with Gypsum Plaster
Counters	Granite / Engineered Stone Countertop or Equivalent
Fixtures/Fittings	Premium grade modular kitchen with premium White goods. Refrigerator – Double Door- (Samsung/LG/IFB/Whirlpool or Equivalent Make) Oven (Miele / Siemens / Bosch or Equivalent Make) Microwave (Miele / Siemens / Bosch or Equivalent Make) Dishwasher (Miele / Siemens / Bosch or Equivalent Make) Washing Machine & Dryer combo (Miele / Siemens / Bosch or Equivalent Make) Hob Chimney (Miele / Siemens / Bosch or Equivalent Make) Geysr (Centralized / Individual of A.O. Smith/Venus/ Racold or Equivalent Make) RO (Centralized / Individual of Kent / Eureka Forbes Or Equivalent) Sink – Double Bowl – (Franke / Jayna or Equivalent Make) Faucet (Grohe / Kohler / American Standard or Equivalent Make)



Artistic illustration



ELAN
THE STATEMENT
FOR GENERATIONS TO COME

SPECIFICATIONS

BALCONIES

Flooring Premium vitrified tiles / Granite or equivalent

UTILITY BALCONY

Floor Superior quality Vitrified/ Anti-Skid Tiles or Equivalent

Wall/Ceiling Gypsum Plaster with Acrylic Emulsion Paint/External Grade Putty
and Exterior Weather Shield or Equivalent

UTILITY ROOM

Floor Vitrified Tiles or Equivalent

Wall Gypsum Plaster with Acrylic Emulsion Paint

Ceiling Gypsum Plaster with Acrylic Emulsion Paint

AC Suitable AC in Servant Room

UTILITY TOILET

Floor Vitrified Tiles or Equivalent

Wall Combination of Vitrified Tiles with Gypsum Plaster & Acrylic Emulsion Paint

Ceiling Moisture Resistant False Ceiling with Acrylic Emulsion Paint

Sanitary ware
and CP Fittings Roca / Hindware or Equivalent Make



Artistic illustration

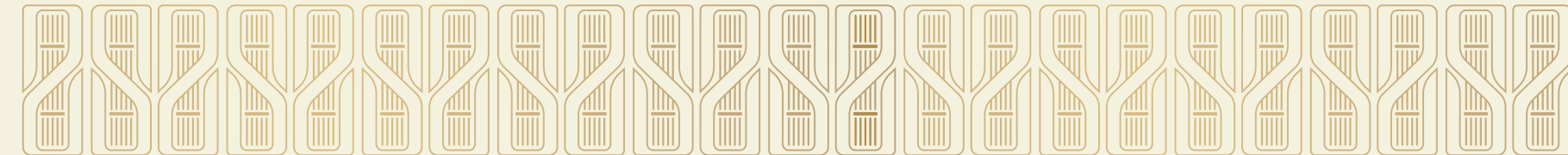



ELAN
THE STATEMENT
FOR GENERATIONS TO COME

SPECIFICATIONS

DOORS

Main door & All Bedroom Doors Hardwood / Engineered Door Frame with Veneer Flush Door in
High Gloss Finish or Equivalent

Other doors Hardwood / Engineered Door Frames with laminated
Flush Doors or Equivalent

EXTERNAL GLAZING

Windows/Glazing Anodised Aluminium Frames/Powder Coated Aluminium/UPvC Glazing

Balcony Railing Seamless modern glass railing / SS balustrade glass railing

AIR CONDITIONING

Energy efficient VRV/VRF Air conditioning system with
centrally treated fresh air.

GENERAL ITEMS

Fixtures/Fittings Switches (Havells/Northwest/Schneider or Equivalent Make)

Ceiling Fans (Crompton/Havells/Orient or Equivalent Make)



Artistic illustration

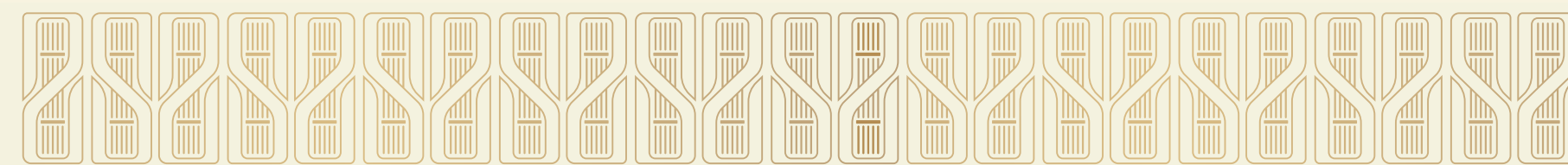



ELAN
THE STATEMENT
FOR GENERATIONS TO COME

SPECIFICATIONS

SECURITY

5 Tier Security-Gate/Perimeter/Parking/Lobby and Entrance Door

Video Door Phone and digital lock on Main Door

Secured Access for Lifts & Lift Lobbies

Access Controlled Reception Areas in each tower

CCTV Coverage for complete development and Lift cars

Separate Lifts for Basement to GF Entrance Lobby connectivity

LIFT LOBBY

Floor Imported Marble/Engineered stone/equivalent

Wall Combination of Imported Marble Cladding / Veneer / Plaster Paint

BASEMENT

Floor Finished with combination of Epoxy paint or Equivalent



Artistic illustration

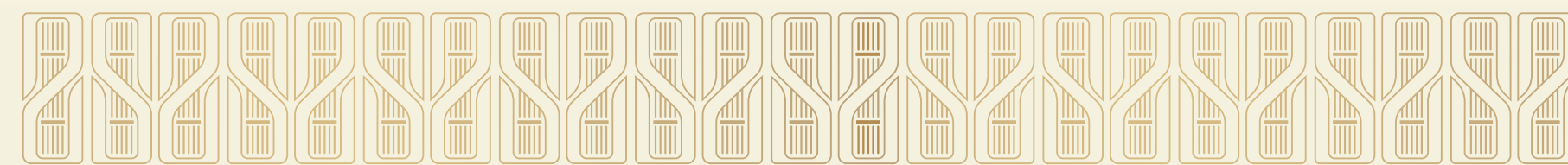

PRICE

25,900/-
PER SQ. FT.

*PLC & OTHER CHARGES AS APPLICABLE



ELAN

THE STATEMENT™

FOR GENERATIONS TO COME



FLOOR PLAN



Tower 1 Ground Floor

The floor plans is illustrative/ Tentative/ Indicative only and subject to change at any time in future as per requirement of Company/ Competent Authority without any prior notice. All images and graphical depictions are purely artistic in nature and may not represent the actual final product.

RESIDENTIAL DEVELOPMENT SECTOR 49, SOHNA ROAD



ELAN
THE STATEMENT™
FOR GENERATIONS TO COME

4 BHK



TOWER KEY PLAN

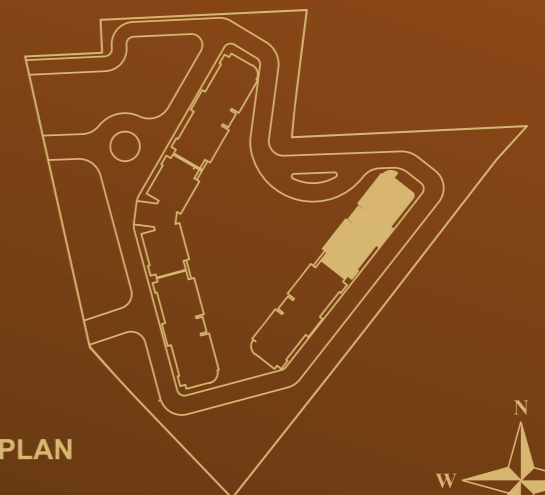

SITE PLAN





4 BHK



TOWER KEY PLAN

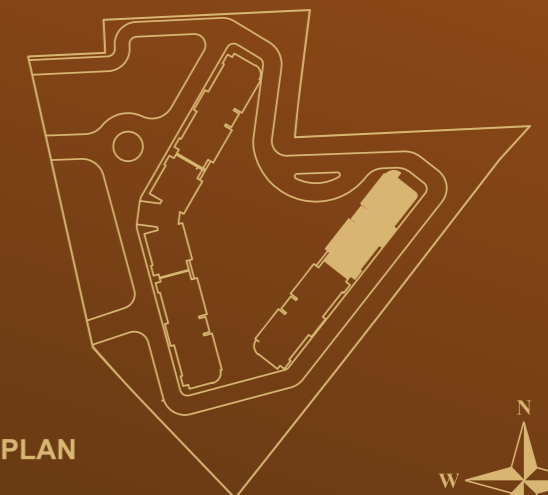

SITE PLAN



Tower 1 Typical Floor

The floor plans is illustrative/ Tentative/ Indicative only and subject to change at any time in future as per requirement of Company/ Competent Authority without any prior notice. All images and graphical depictions are purely artistic in nature and may not represent the actual final product.



Carpet Area : 2586 sq. ft.
Covered Area (FAR) : 2816 sq. ft.
Balcony Area (Non FAR) : 430 sq. ft.
Super Area : 4285 sq. ft.

Tower 1

101	201	301	401	501	601	701	801	901	1001	1101	1201	1401	1501	1601	1701	1801	1901	2001	2101	2201	2301	2401	2501	2601	2701	2801	2901	3001	3101	3201	3301	3401	3501	3601	3701	3801
-----	-----	-----	-----	-----	-----	-----	-----	-----	------	------	------	------	------	------	------	------	------	------	------	------	------	------	------	------	------	------	------	------	------	------	------	------	------	------	------	------

The floor plans is illustrative/ Tentative/ Indicative only and subject to change at any time in future as per requirement of Company/ Competent Authority without any prior notice. All images and graphical depictions are purely artistic in nature and may not represent the actual final product.



ELAN
THE STATEMENT
FOR GENERATIONS TO COME

**4 BHK
WING UNIT**

(1 MASTER SUITE + 1 MASTER BEDROOM + 1 JUNIOR MASTER BEDROOM + 1 BEDROOM + FAMILY LOUNGE + POWDER TOILET + PRIVATE DECK + SERVANT ROOM + PRIVATE LIFT LOBBY)



TOWER KEY PLAN

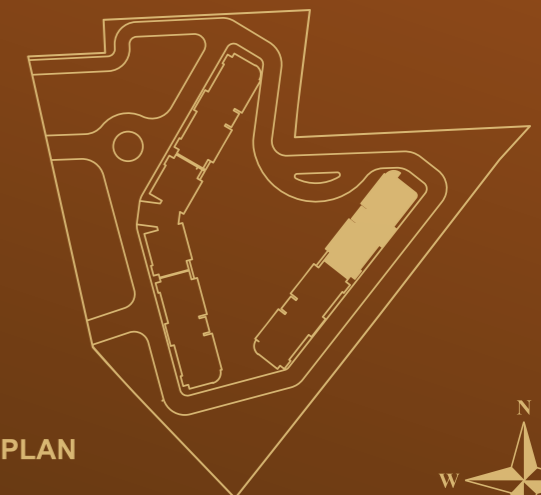

SITE PLAN





Upper Penthouse



Lower Penthouse

- Carpet Area** : 4053 sq. ft.
- Covered Area (FAR)** : 4426 sq. ft.
- Balcony Area (Non FAR)** : 411 sq. ft.
- Sky Deck** : 781 sq. ft.
- Super Area** : 7250 sq. ft.

Tower 1

3901

The floor plans is illustrative/ Tentative/ Indicative only and subject to change at any time in future as per requirement of Company/ Competent Authority without any prior notice. All images and graphical depictions are purely artistic in nature and may not represent the actual final product.



ELAN
THE STATEMENT
FOR GENERATIONS TO COME

**4 BHK
PENT HOUSE**

(2 MASTER SUITE + 1 JUNIOR MASTER BEDROOM + 1 BEDROOM + FAMILY LOUNGE + POWDERTOILET + PRIVATE DECK + SKY DECK + 2 SERVANT ROOM + PRIVATE LIFT LOBBY + PRIVATE LIFT + JACUZZI POOL)



TOWER KEY PLAN

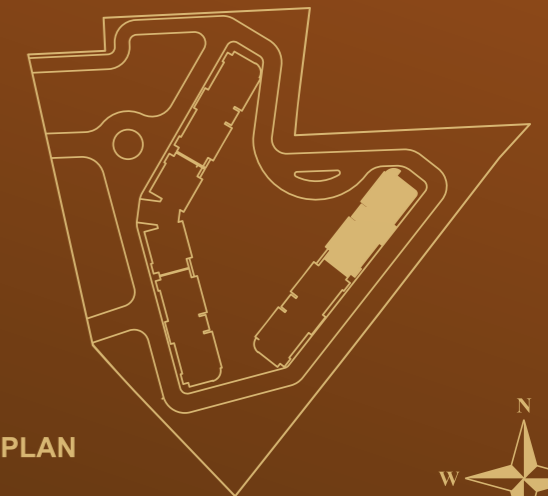

SITE PLAN





4 BHK



TOWER KEY PLAN

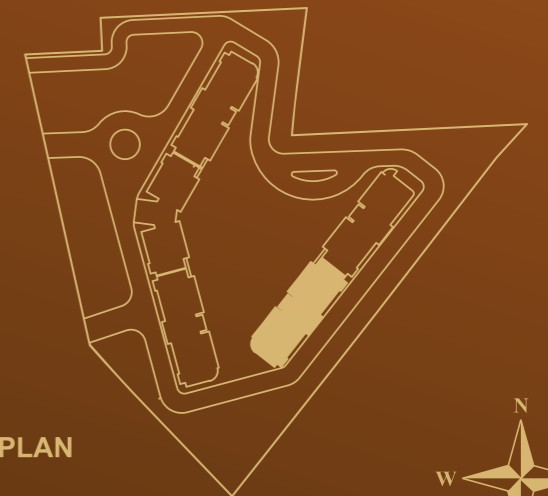

SITE PLAN

Tower 2 Ground Floor

The floor plans is illustrative/ Tentative/ Indicative only and subject to change at any time in future as per requirement of Company/ Competent Authority without any prior notice. All images and graphical depictions are purely artistic in nature and may not represent the actual final product.



4 BHK



TOWER KEY PLAN

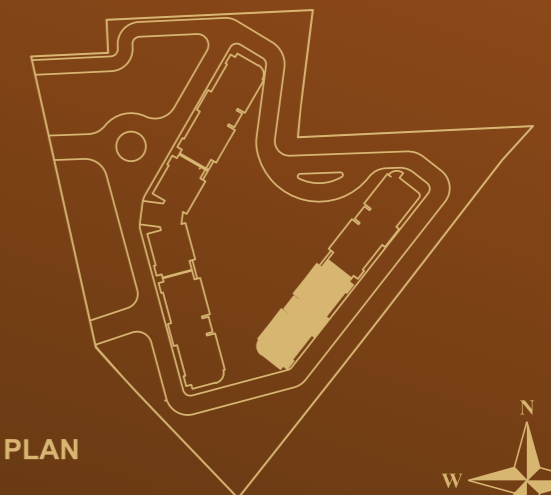

SITE PLAN

Tower 2 Typical Floor

The floor plans is illustrative/ Tentative/ Indicative only and subject to change at any time in future as per requirement of Company/ Competent Authority without any prior notice. All images and graphical depictions are purely artistic in nature and may not represent the actual final product.



4 BHK WING UNIT

(1 MASTER SUITE + 1 MASTER BEDROOM + 1 JUNIOR MASTER BEDROOM + 1 BEDROOM + FAMILY LOUNGE + POWDER TOILET + PRIVATE DECK + SERVANT ROOM + PRIVATE LIFT LOBBY)



TOWER KEY PLAN

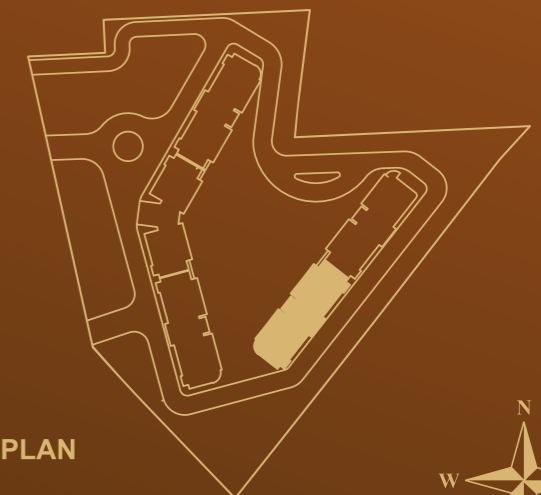

SITE PLAN



Carpet Area : 2586 sq. ft.
Covered Area (FAR) : 2824 sq. ft.
Balcony Area (Non FAR) : 420 sq. ft.
Super Area : 4285 sq. ft.

Tower 2

101	201	301	401	501	601	701	801	901	1001	1101	1201	1401	1501	1601	1701	1801	1901	2001	2101	2201	2301	2401	2501	2601	2701	2801	2901	3001	3101	3201	3301	3401	3501	3601	3701	3801
-----	-----	-----	-----	-----	-----	-----	-----	-----	------	------	------	------	------	------	------	------	------	------	------	------	------	------	------	------	------	------	------	------	------	------	------	------	------	------	------	------

The floor plans is illustrative/ Tentative/ Indicative only and subject to change at any time in future as per requirement of Company/ Competent Authority without any prior notice. All images and graphical depictions are purely artistic in nature and may not represent the actual final product.



Carpet Area : 2586 sq. ft.
Covered Area (FAR) : 2816 sq. ft.
Balcony Area (Non FAR) : 430 sq. ft.
Super Area : 4285 sq. ft.

Tower 2

102	202	302	402	502	602	702	802	902	1002	1102	1202	1402	1502	1602	1702	1802	1902	2002	2102	2202	2302	2402	2502	2602	2702	2802	2902	3002	3102	3202	3302	3402	3502	3602	3702	3802
-----	-----	-----	-----	-----	-----	-----	-----	-----	------	------	------	------	------	------	------	------	------	------	------	------	------	------	------	------	------	------	------	------	------	------	------	------	------	------	------	------

The floor plans is illustrative/ Tentative/ Indicative only and subject to change at any time in future as per requirement of Company/ Competent Authority without any prior notice. All images and graphical depictions are purely artistic in nature and may not represent the actual final product.



ELAN
THE STATEMENT™
FOR GENERATIONS TO COME

**4 BHK
WING UNIT**

(1 MASTER SUITE + 1 MASTER BEDROOM + 1 JUNIOR MASTER BEDROOM + 1 BEDROOM + FAMILY LOUNGE + POWDER TOILET + PRIVATE DECK + SERVANT ROOM + PRIVATE LIFT LOBBY)



TOWER KEY PLAN

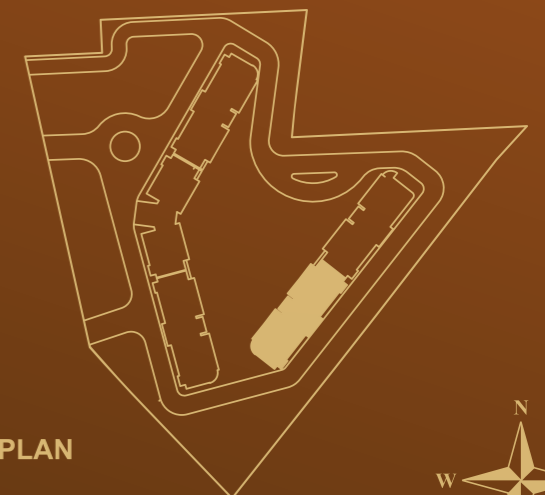

SITE PLAN





Upper Penthouse



Lower Penthouse

Carpet Area : 4053 sq. ft.
Covered Area (FAR) : 4433 sq. ft.
Balcony Area (Non FAR) : 400 sq. ft.
Sky Deck : 800 sq. ft.
Super Area : 7270 sq. ft.

Tower 2

3901

The floor plans is illustrative/ Tentative/ Indicative only and subject to change at any time in future as per requirement of Company/ Competent Authority without any prior notice. All images and graphical depictions are purely artistic in nature and may not represent the actual final product.



ELAN
THE STATEMENT™
FOR GENERATIONS TO COME

**4 BHK
PENT HOUSE**

(2 MASTER SUITE + 1 JUNIOR MASTER BEDROOM + 1 BEDROOM + FAMILY LOUNGE + POWDERTOILET + PRIVATE DECK + SKY DECK + 2 SERVANT ROOM + PRIVATE LIFT LOBBY + PRIVATE LIFT + JACUZZI POOL)



TOWER KEY PLAN

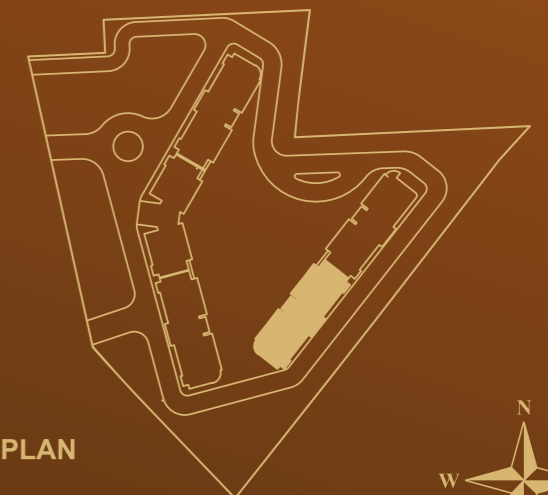

SITE PLAN



Upper Penthouse



Lower Penthouse

Carpet Area : 4053 sq. ft.
Covered Area (FAR) : 4426 sq. ft.
Balcony Area (Non FAR) : 411 sq. ft.
Sky Deck : 781 sq. ft.
Super Area : 7250 sq. ft.

Tower 2

3902

The floor plans is illustrative/ Tentative/ Indicative only and subject to change at any time in future as per requirement of Company/ Competent Authority without any prior notice. All images and graphical depictions are purely artistic in nature and may not represent the actual final product.



ELAN
THE STATEMENT™
 FOR GENERATIONS TO COME

**4 BHK
 PENT HOUSE**

(2 MASTER SUITE + 1 JUNIOR MASTER BEDROOM
 + 1 BEDROOM + FAMILY LOUNGE + POWDERTOILET
 + PRIVATE DECK + SKY DECK + 2 SERVANT ROOM +
 PRIVATE LIFT LOBBY + PRIVATE LIFT + JACUZZI POOL)



TOWER KEY PLAN

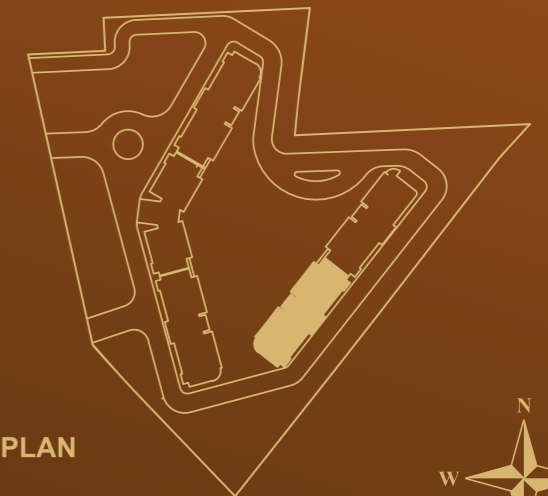

SITE PLAN



4 BHK



TOWER KEY PLAN

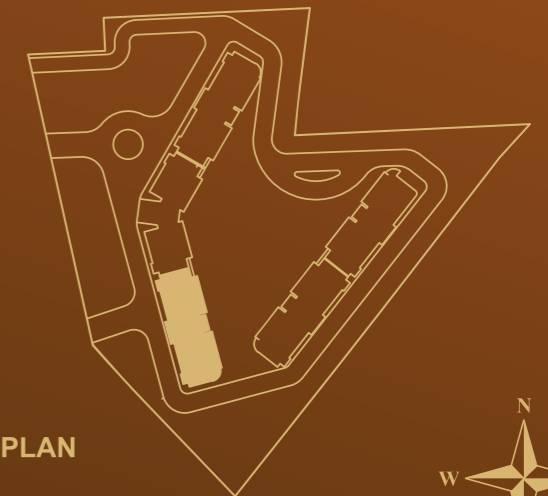

SITE PLAN

Tower 3 Ground Floor

The floor plans is illustrative/ Tentative/ Indicative only and subject to change at any time in future as per requirement of Company/ Competent Authority without any prior notice. All images and graphical depictions are purely artistic in nature and may not represent the actual final product.



4 BHK



TOWER KEY PLAN

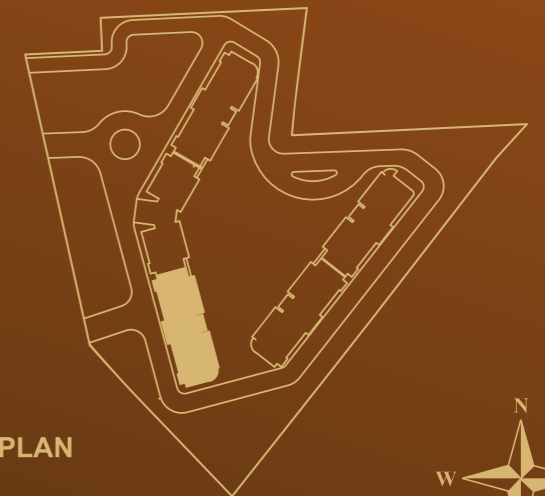

SITE PLAN

Tower 3 Typical Floor

The floor plans is illustrative/ Tentative/ Indicative only and subject to change at any time in future as per requirement of Company/ Competent Authority without any prior notice. All images and graphical depictions are purely artistic in nature and may not represent the actual final product.



4 BHK WING UNIT

(1 MASTER SUITE + 1 MASTER BEDROOM + 1 JUNIOR MASTER BEDROOM + 1 BEDROOM + FAMILY LOUNGE + POWDER TOILET + PRIVATE DECK + SERVANT ROOM + PRIVATE LIFT LOBBY)



TOWER KEY PLAN

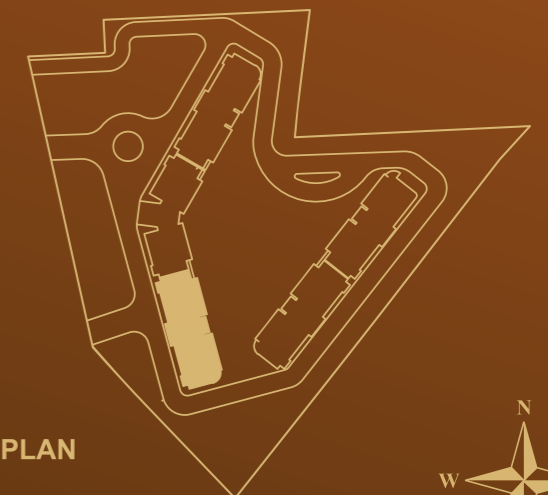

SITE PLAN



Carpet Area : 2586 sq. ft.
Covered Area (FAR) : 2816 sq. ft.
Balcony Area (Non FAR) : 430 sq. ft.
Super Area : 4285 sq. ft.

Tower 3

101	201	301	401	501	601	701	801	901	1001	1101	1201	1401	1501	1601	1701	1801	1901	2001	2101	2201	2301	2401	2501	2601	2701	2801	2901	3001	3101	3201	3301	3401	3501	3601	3701	3801
-----	-----	-----	-----	-----	-----	-----	-----	-----	------	------	------	------	------	------	------	------	------	------	------	------	------	------	------	------	------	------	------	------	------	------	------	------	------	------	------	------

The floor plans is illustrative/ Tentative/ Indicative only and subject to change at any time in future as per requirement of Company/ Competent Authority without any prior notice. All images and graphical depictions are purely artistic in nature and may not represent the actual final product.



4 BHK WING UNIT

(1 MASTER SUITE + 1 MASTER BEDROOM + 1 JUNIOR MASTER BEDROOM + 1 BEDROOM + FAMILY LOUNGE + POWDER TOILET + PRIVATE DECK + SERVANT ROOM + PRIVATE LIFT LOBBY)



TOWER KEY PLAN

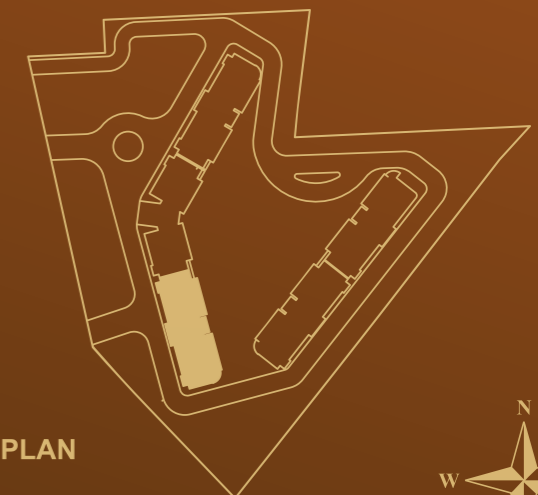

SITE PLAN

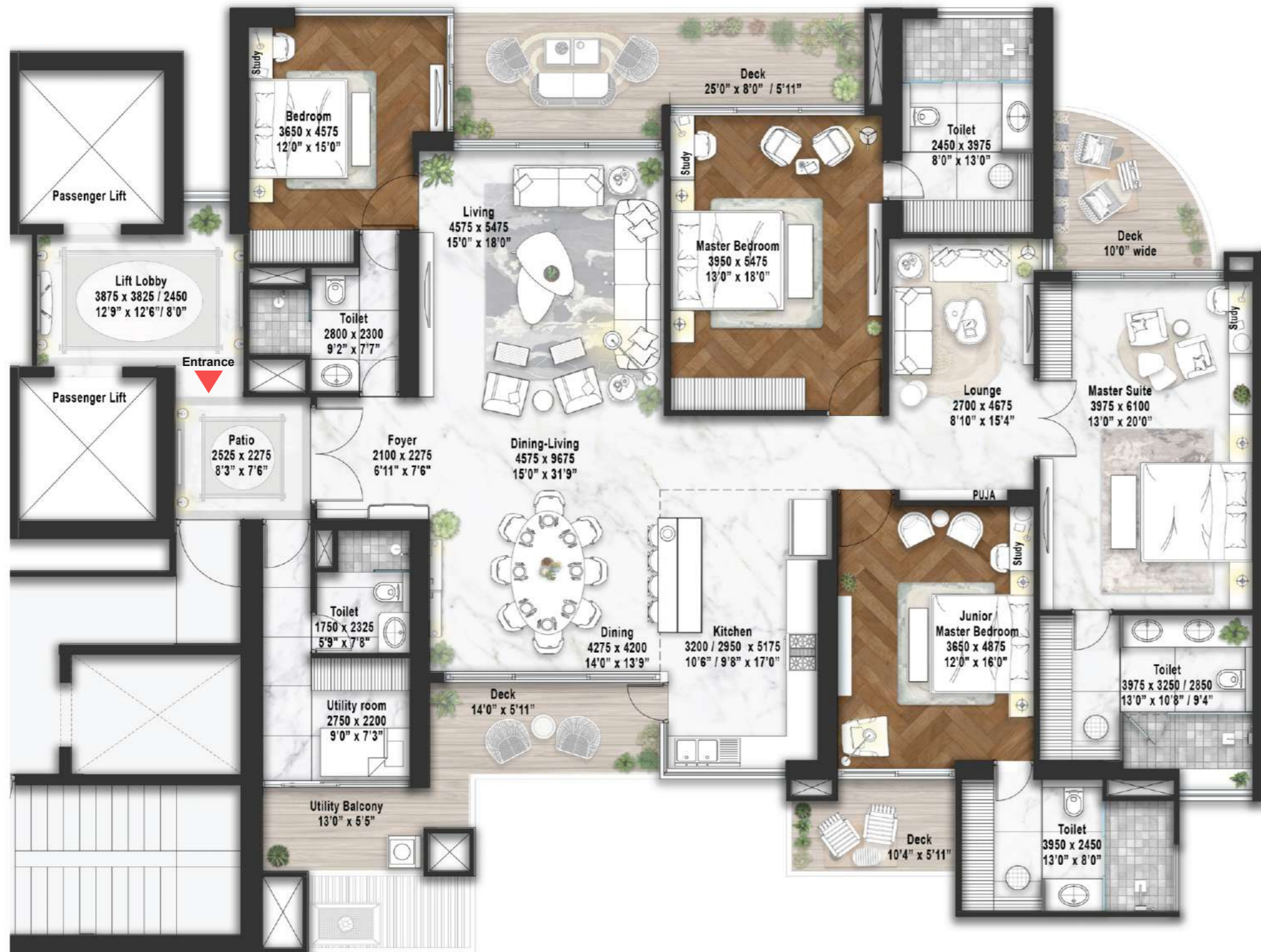

Carpet Area : 2586 sq. ft.
Covered Area (FAR) : 2824 sq. ft.
Balcony Area (Non FAR) : 420 sq. ft.
Super Area : 4285 sq. ft.

Tower 3

102	202	302	402	502	602	702	802	902	1002	1102	1202	1402	1502	1602	1702	1802	1902	2002	2102	2202	2302	2402	2502	2602	2702	2802	2902	3002	3102	3202	3302	3402	3502	3602	3702	3802
-----	-----	-----	-----	-----	-----	-----	-----	-----	------	------	------	------	------	------	------	------	------	------	------	------	------	------	------	------	------	------	------	------	------	------	------	------	------	------	------	------

The floor plans is illustrative/ Tentative/ Indicative only and subject to change at any time in future as per requirement of Company/ Competent Authority without any prior notice. All images and graphical depictions are purely artistic in nature and may not represent the actual final product.



Upper Penthouse



Lower Penthouse

Carpet Area : 4053 Sq. Ft.
Covered Area (FAR) : 4426 Sq. Ft.
Balcony Area (Non FAR) : 411 Sq. Ft.
Sky Deck : 781 Sq. Ft.
Super Area : 7250 Sq. Ft.

Tower 3

3901

The floor plans is illustrative/ Tentative/ Indicative only and subject to change at any time in future as per requirement of Company/ Competent Authority without any prior notice. All images and graphical depictions are purely artistic in nature and may not represent the actual final product.



ELAN
THE STATEMENT™
 FOR GENERATIONS TO COME

**4 BHK
 PENT HOUSE**

(2 MASTER SUITE + 1 JUNIOR MASTER BEDROOM
 + 1 BEDROOM + FAMILY LOUNGE + POWDERTOILET
 + PRIVATE DECK + SKY DECK + 2 SERVANT ROOM +
 PRIVATE LIFT LOBBY + PRIVATE LIFT + JACUZZI POOL)



TOWER KEY PLAN

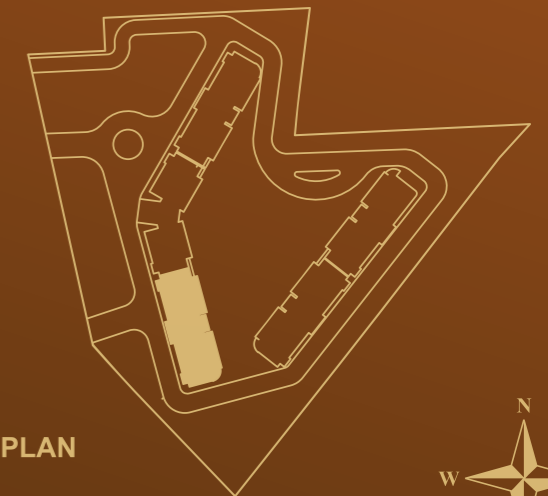

SITE PLAN





Upper Penthouse



Lower Penthouse

- Carpet Area** : 4053 sq. ft.
- Covered Area (FAR)** : 4433 sq. ft.
- Balcony Area (Non FAR)** : 400 sq. ft.
- Sky Deck** : 800 sq. ft.
- Super Area** : 7270 sq. ft.

Tower 3

3902

The floor plans is illustrative/ Tentative/ Indicative only and subject to change at any time in future as per requirement of Company/ Competent Authority without any prior notice. All images and graphical depictions are purely artistic in nature and may not represent the actual final product.



ELAN
THE STATEMENT™

FOR GENERATIONS TO COME

4 BHK
PENT HOUSE

(2 MASTER SUITE + 1 JUNIOR MASTER BEDROOM + 1 BEDROOM + FAMILY LOUNGE + POWDERTOILET + PRIVATE DECK + SKY DECK + 2 SERVANT ROOM + PRIVATE LIFT LOBBY + PRIVATE LIFT + JACUZZI POOL)



TOWER KEY PLAN

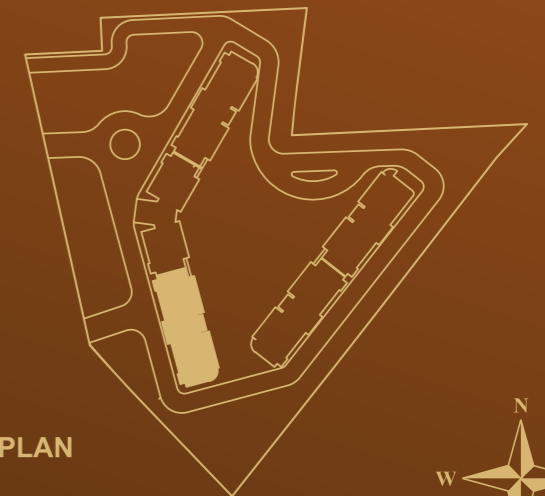

SITE PLAN





4 BHK

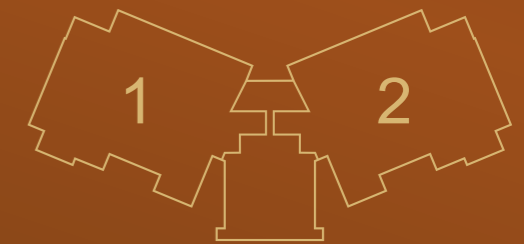

TOWER KEY PLAN

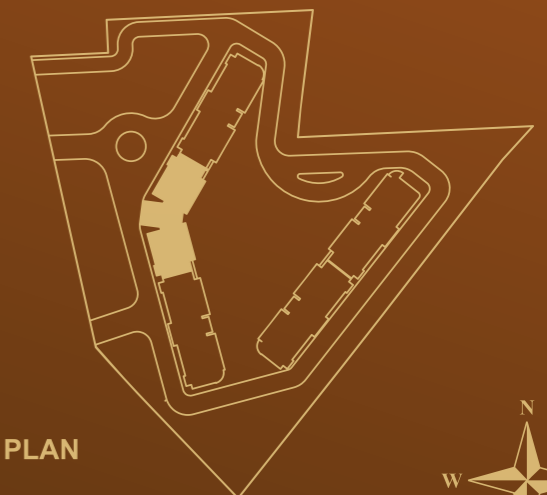

SITE PLAN

Tower 4 Ground Floor

The floor plans are illustrative/indicative only and subject to change at any time in future as per requirement of Company/Competent Authority without any prior notice. All images and graphical depictions are purely artistic in nature and may not represent the actual final product.

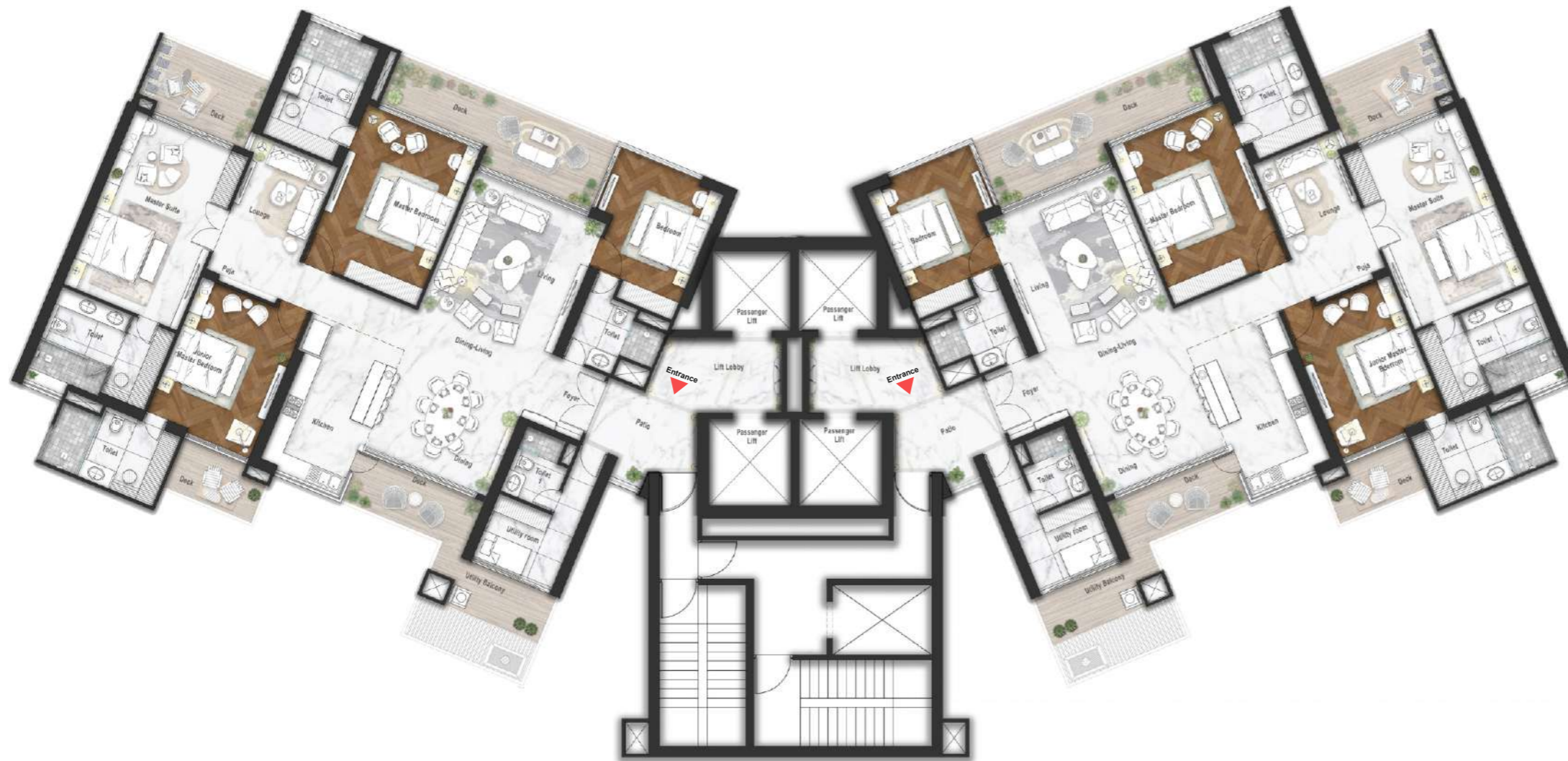

4 BHK

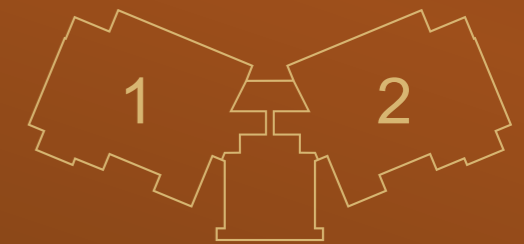

TOWER KEY PLAN

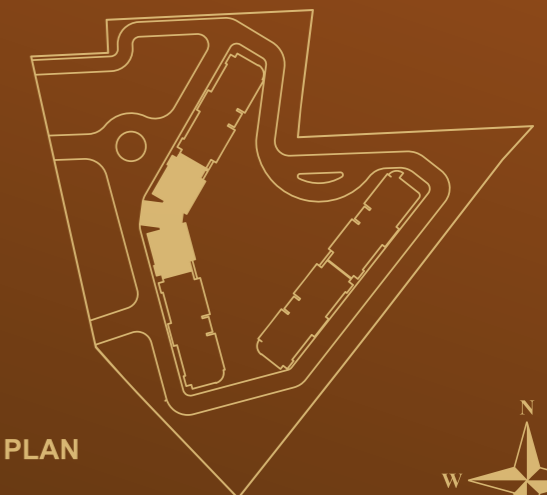

SITE PLAN

Tower 4 Typical Floor

The floor plans is illustrative/ Tentative/ Indicative only and subject to change at any time in future as per requirement of Company/ Competent Authority without any prior notice. All images and graphical depictions are purely artistic in nature and may not represent the actual final product.



4 BHK WING UNIT

(1 MASTER SUITE + 1 MASTER BEDROOM + 1 JUNIOR MASTER BEDROOM + 1 BEDROOM + FAMILY LOUNGE + POWDER TOILET + PRIVATE DECK + SERVANT ROOM + PRIVATE LIFT LOBBY)



TOWER KEY PLAN

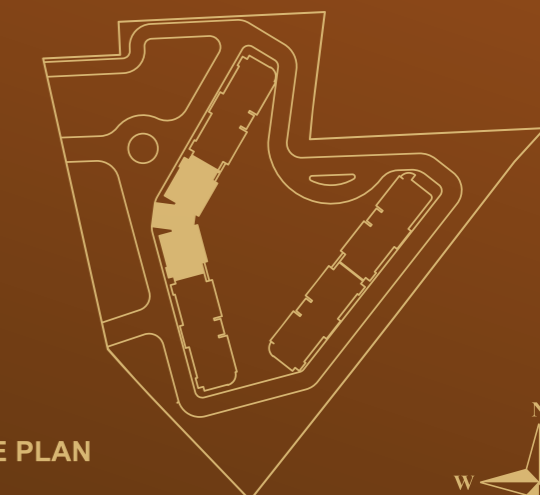

SITE PLAN

Carpet Area : 2604 sq. ft.
Covered Area (FAR) : 2851 sq. ft.
Balcony Area (Non FAR) : 437 sq. ft.
Super Area : 4340 sq. ft.

Tower 4

101	201	301	401	501	601	701	801	901	1001	1101	1201	1401	1501	1601	1701	1801	1901	2001	2101	2201	2301	2401	2501	2601	2701	2801	2901	3001	3101	3201	3301	3401	3501	3601	3701	3801
-----	-----	-----	-----	-----	-----	-----	-----	-----	------	------	------	------	------	------	------	------	------	------	------	------	------	------	------	------	------	------	------	------	------	------	------	------	------	------	------	------

The floor plans is illustrative/ Tentative/ Indicative only and subject to change at any time in future as per requirement of Company/ Competent Authority without any prior notice. All images and graphical depictions are purely artistic in nature and may not represent the actual final product.



Carpet Area : 2604 sq. ft.
Covered Area (FAR) : 2851 sq. ft.
Balcony Area (Non FAR) : 437 sq. ft.
Super Area : 4340 sq. ft.

Tower 4

102	202	302	402	502	602	702	802	902	1002	1102	1202	1402	1502	1602	1702	1802	1902	2002	2102	2202	2302	2402	2502	2602	2702	2802	2902	3002	3102	3202	3302	3402	3502	3602	3702	3802
-----	-----	-----	-----	-----	-----	-----	-----	-----	------	------	------	------	------	------	------	------	------	------	------	------	------	------	------	------	------	------	------	------	------	------	------	------	------	------	------	------

The floor plans is illustrative/ Tentative/ Indicative only and subject to change at any time in future as per requirement of Company/ Competent Authority without any prior notice. All images and graphical depictions are purely artistic in nature and may not represent the actual final product.

RESIDENTIAL DEVELOPMENT SECTOR 49, SOHNA ROAD



ELAN
THE STATEMENT
FOR GENERATIONS TO COME

**4 BHK
WING UNIT**

(1 MASTER SUITE + 1 MASTER BEDROOM + 1 JUNIOR MASTER BEDROOM + 1 BEDROOM + FAMILY LOUNGE + POWDER TOILET + PRIVATE DECK + SERVANT ROOM + PRIVATE LIFT LOBBY)

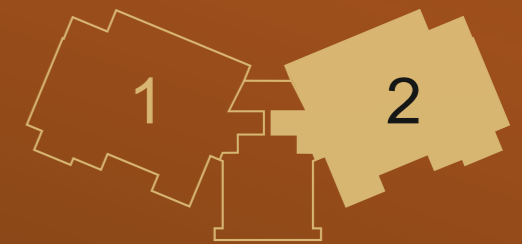

TOWER KEY PLAN

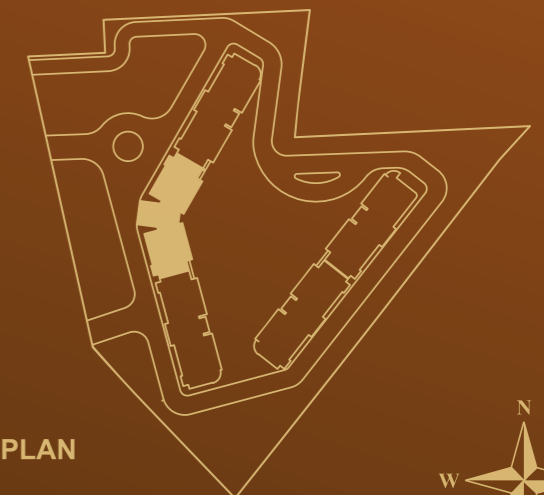

SITE PLAN





Upper Penthouse



Lower Penthouse

Carpet Area : 4071 sq. ft.
Covered Area (FAR) : 4510 sq. ft.
Balcony Area (Non FAR) : 417 sq. ft.
Sky Deck : 805 sq. ft.
Super Area : 7395 sq. ft.

Tower 4

3902

The floor plans is illustrative/ Tentative/ Indicative only and subject to change at any time in future as per requirement of Company/ Competent Authority without any prior notice. All images and graphical depictions are purely artistic in nature and may not represent the actual final product.



ELAN
THE STATEMENT
FOR GENERATIONS TO COME

**4 BHK
PENT HOUSE**

(2 MASTER SUITE + 1 JUNIOR MASTER BEDROOM + 1 BEDROOM + FAMILY LOUNGE + POWDERTOILET + PRIVATE DECK + SKY DECK + 2 SERVANT ROOM + PRIVATE LIFT LOBBY + PRIVATE LIFT + JACUZZI POOL)

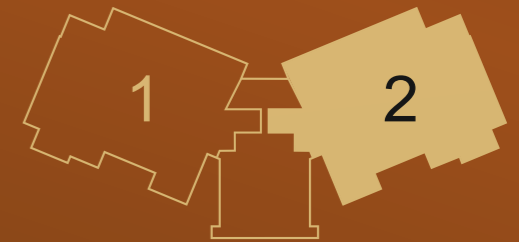

TOWER KEY PLAN

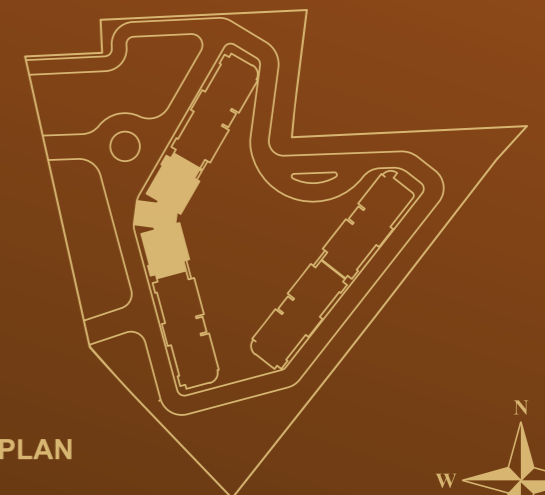

SITE PLAN



4 BHK



TOWER KEY PLAN

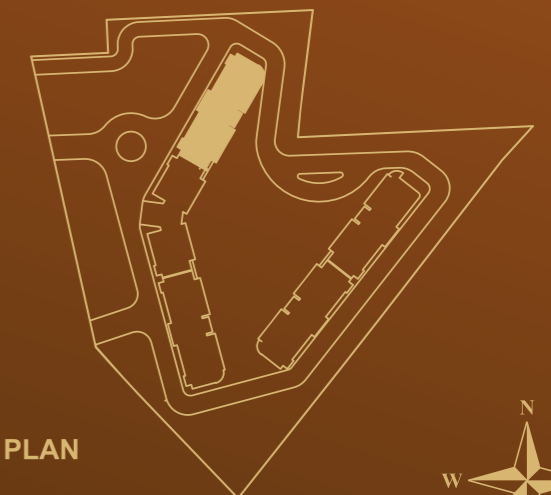

SITE PLAN

Tower 5 Ground Floor

The floor plans are illustrative/ Tentative/ Indicative only and subject to change at any time in future as per requirement of Company/ Competent Authority without any prior notice. All images and graphical depictions are purely artistic in nature and may not represent the actual final product.



4 BHK



TOWER KEY PLAN

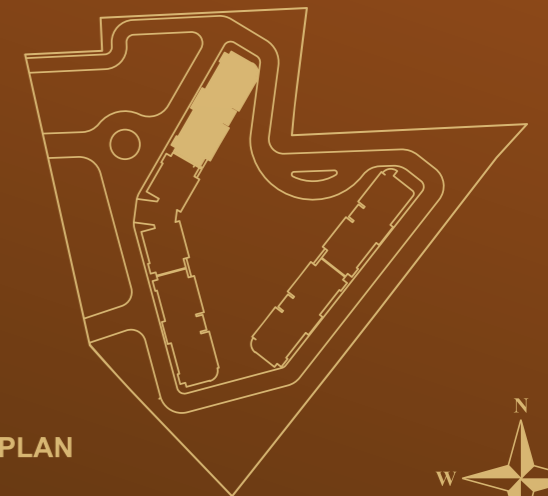

SITE PLAN

Tower 5 Typical Floor

The floor plans is illustrative/ Tentative/ Indicative only and subject to change at any time in future as per requirement of Company/ Competent Authority without any prior notice. All images and graphical depictions are purely artistic in nature and may not represent the actual final product.



Carpet Area : 2586 sq. ft.
Covered Area (FAR) : 2824 sq. ft.
Balcony Area (Non FAR) : 420 sq. ft.
Super Area : 4285 sq. ft.

Tower 5

101	201	301	401	501	601	701	801	901	1001	1101	1201	1401	1501	1601	1701	1801	1901	2001	2101	2201	2301	2401	2501	2601	2701	2801	2901	3001	3101	3201	3301	3401	3501	3601	3701	3801
-----	-----	-----	-----	-----	-----	-----	-----	-----	------	------	------	------	------	------	------	------	------	------	------	------	------	------	------	------	------	------	------	------	------	------	------	------	------	------	------	------

The floor plans is illustrative/ Tentative/ Indicative only and subject to change at any time in future as per requirement of Company/ Competent Authority without any prior notice. All images and graphical depictions are purely artistic in nature and may not represent the actual final product.



ELAN
THE STATEMENT™
 FOR GENERATIONS TO COME

4 BHK WING UNIT

(1 MASTER SUITE + 1 MASTER BEDROOM + 1 JUNIOR
 MASTER BEDROOM + 1 BEDROOM + FAMILY LOUNGE +
 POWDER TOILET + PRIVATE DECK + SERVANT ROOM +
 PRIVATE LIFT LOBBY)



TOWER KEY PLAN

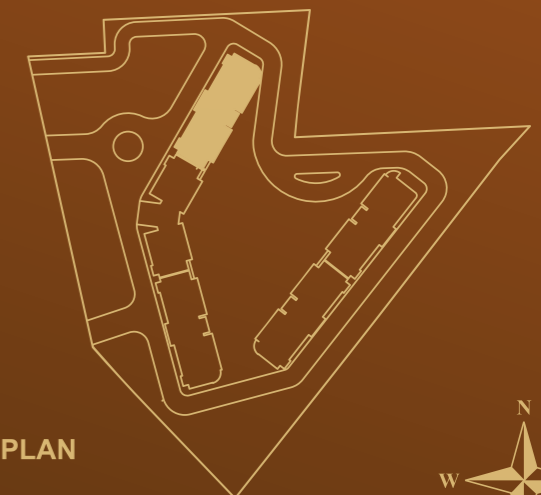

SITE PLAN



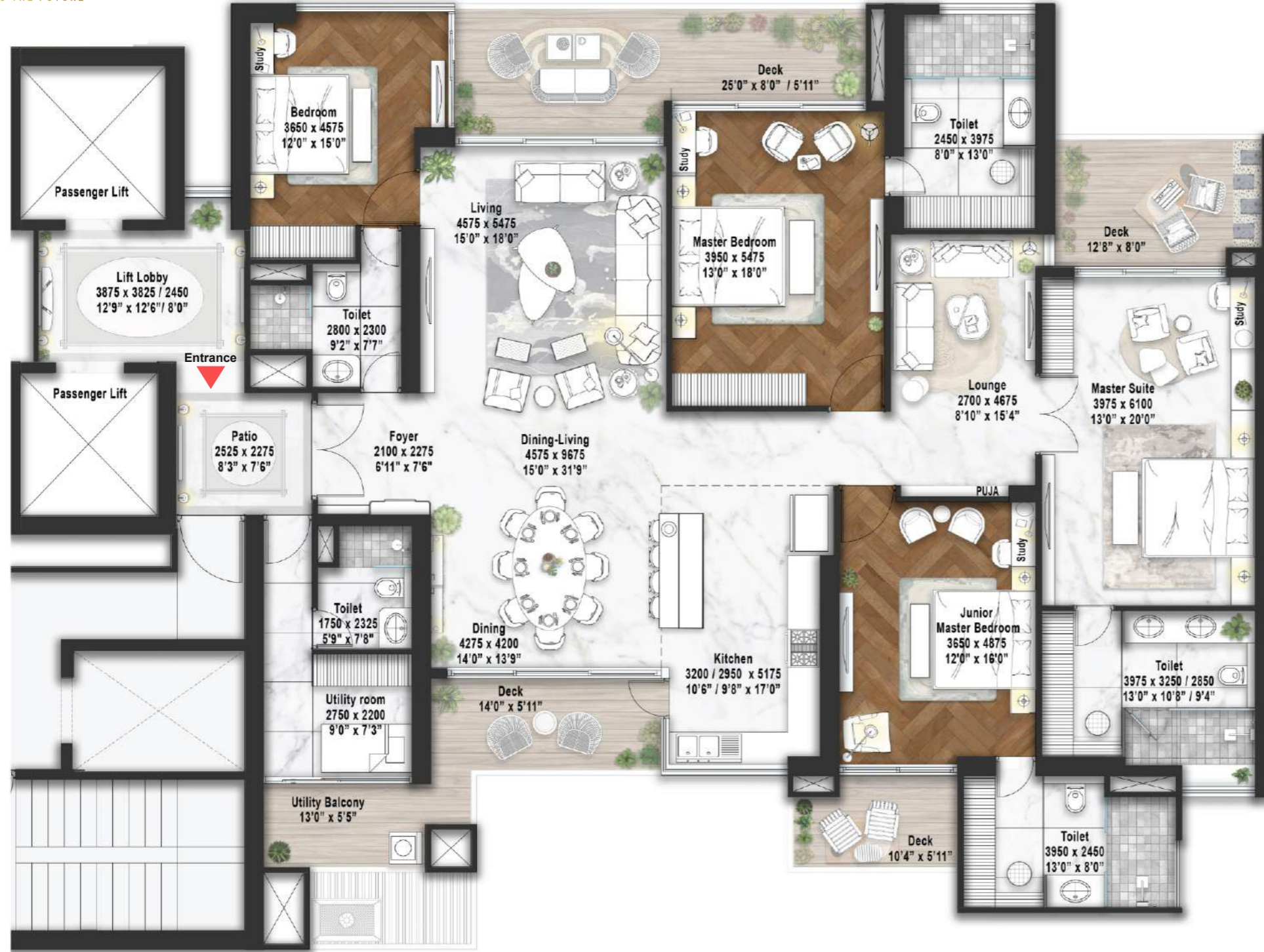

Carpet Area : 2586 sq. ft.
Covered Area (FAR) : 2816 sq. ft.
Balcony Area (Non FAR) : 430 sq. ft.
Super Area : 4285 sq. ft.

Tower 5

102	202	302	402	502	602	702	802	902	1002	1102	1202	1402	1502	1602	1702	1802	1902	2002	2102	2202	2302	2402	2502	2602	2702	2802	2902	3002	3102	3202	3302	3402	3502	3602	3702	3802
-----	-----	-----	-----	-----	-----	-----	-----	-----	------	------	------	------	------	------	------	------	------	------	------	------	------	------	------	------	------	------	------	------	------	------	------	------	------	------	------	------

The floor plans is illustrative/ Tentative/ Indicative only and subject to change at any time in future as per requirement of Company/ Competent Authority without any prior notice. All images and graphical depictions are purely artistic in nature and may not represent the actual final product.

RESIDENTIAL DEVELOPMENT SECTOR 49, SOHNA ROAD



ELAN
THE STATEMENT™
FOR GENERATIONS TO COME

**4 BHK
WING UNIT**

(1 MASTER SUITE + 1 MASTER BEDROOM + 1 JUNIOR MASTER BEDROOM + 1 BEDROOM + FAMILY LOUNGE + POWDER TOILET + PRIVATE DECK + SERVANT ROOM + PRIVATE LIFT LOBBY)



TOWER KEY PLAN

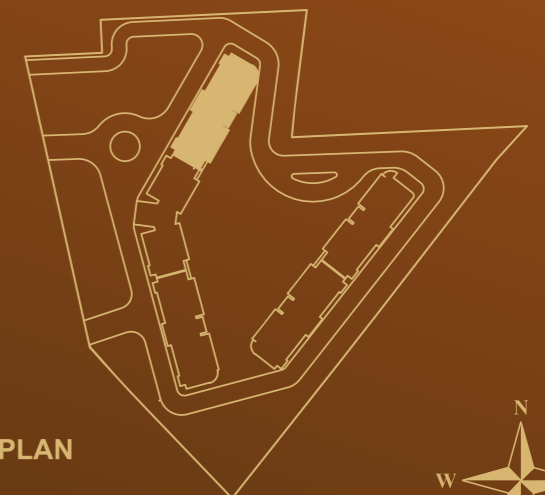

SITE PLAN





Upper Penthouse



Lower Penthouse

Carpets Area	:	4053 sq. ft.
Covered Area (FAR)	:	4433 sq. ft.
Balcony Area (Non FAR)	:	400 sq. ft.
Sky Deck	:	800 sq. ft.
Super Area	:	7270 sq. ft.

Tower 5

3901

The floor plans is illustrative/ Tentative/ Indicative only and subject to change at any time in future as per requirement of Company/ Competent Authority without any prior notice. All images and graphical depictions are purely artistic in nature and may not represent the actual final product.



ELAN
THE STATEMENT™
FOR GENERATIONS TO COME

4 BHK PENT HOUSE

(2 MASTER SUITE + 1 JUNIOR MASTER BEDROOM
+ 1 BEDROOM + FAMILY LOUNGE + POWDERTOILET
+ PRIVATE DECK + SKY DECK + 2 SERVANT ROOM +
PRIVATE LIFT LOBBY + PRIVATE LIFT + JACUZZI POOL)



TOWER KEY PLAN

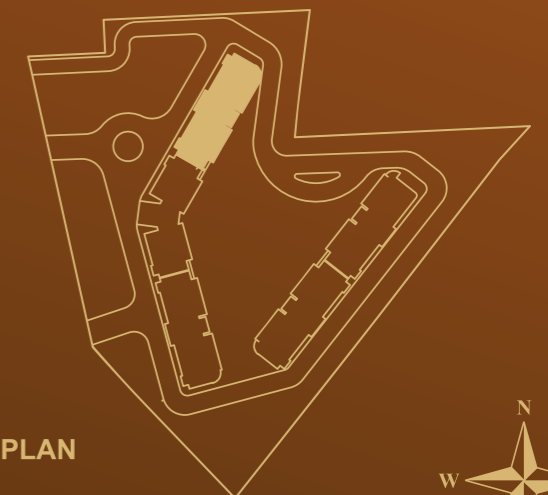

SITE PLAN





Upper Penthouse



Lower Penthouse

Carpet Area : 4053 sq. ft.
Covered Area (FAR) : 4426 sq. ft.
Balcony Area (Non FAR) : 411 sq. ft.
Sky Deck : 781 sq. ft.
Super Area : 7250 sq. ft.

Tower 5

3902

The floor plans is illustrative/ Tentative/ Indicative only and subject to change at any time in future as per requirement of Company/ Competent Authority without any prior notice. All images and graphical depictions are purely artistic in nature and may not represent the actual final product.



ELAN
THE STATEMENT™
 FOR GENERATIONS TO COME

**4 BHK
 PENT HOUSE**

(2 MASTER SUITE + 1 JUNIOR MASTER BEDROOM
 + 1 BEDROOM + FAMILY LOUNGE + POWDERTOILET
 + PRIVATE DECK + SKY DECK + 2 SERVANT ROOM +
 PRIVATE LIFT LOBBY + PRIVATE LIFT + JACUZZI POOL)



TOWER KEY PLAN

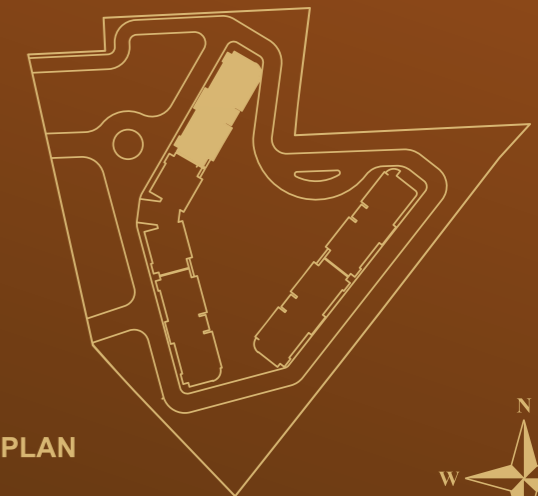

SITE PLAN





ELAN

THE STATEMENT

FOR GENERATIONS TO COME

DISCLAIMER: Nothing herein intends to constitute legal offering / binding on part of Elan Enclave Pvt. Ltd. (“Company”). All images (other than actual images) are merely artistic conceptualization and should not be relied on as a definitive reference. “Elan The Statement”, HARERA Regn. No. 125 of 2025 dt. 12.12.2025.

